

Steamin Demon® *Classic*

High-Flow Carpet Cleaning System

Repair Manual & Parts List

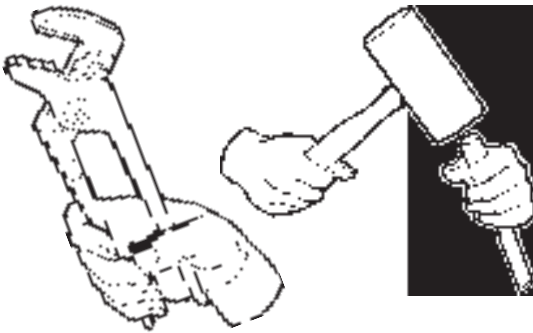

Steamin Demon

For technical assistance or to
order parts, call toll-free

1-888-413-6748

Fax: 740-587-1394, Email: info@steaindemon.com

TABLE OF CONTENTS

	Page #
Removing Engine Compartment Cover	2
Removing Discharge Pump	2
Replacing Pump's Impeller	3
Replacing Float Switch	4
Replacing Vacuum Motor	4
Replacing Solenoid	5
Replacing the Defoamer Valve	6
Cleaning Defoamer Valve	6
Removing and Replacing Switches	6
Parts Diagrams & Lists	7-15
Terminal Block Diagrams	16

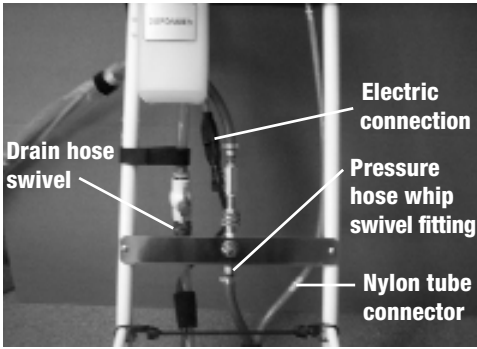

Figure 1

Removing Engine Compartment Cover

1. Unplug machine at outlet.
2. Unswivel both pressure hose whip swivel fitting and drain hose swivel (fig. 1). Unplug electrical connection and pull defoamer tube off nylon tube connector (fig. 1).

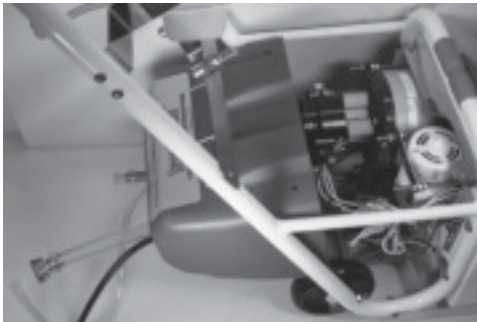

Figure 2

3. Unscrew black thumb knobs from top of engine compartment cover. Lift top of cover straight up off of bolts and pull it back (fig. 2).

Removing Discharge Pump

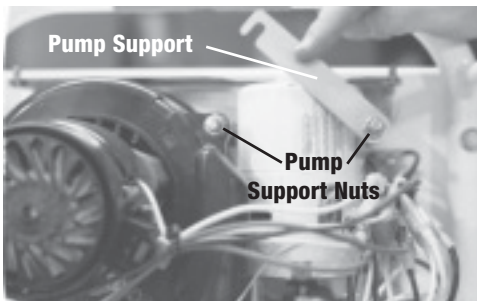

Figure 3

1. Unplug machine at outlet.
2. Remove engine compartment cover (refer to above: Removing Engine Compartment Cover).

3. Loosen pump support nuts and push pump support up (fig. 3).



Figure 4

4. Using a 1 1/16" socket (optional accessory), remove the pump mount brass fitting (fig. 4).

5. Unscrew pump's ground wire and separate pump's black and white wires at their quick-connects. You may need to use a pair of pliers or needle-nose on either side of quick-connect to separate. (Fig. 5).

6. Remove and replace pump (refer to page 16: Engine Compartment Terminal Block Diagram for wiring instructions).

Replacing Pump's Impeller

1. Unplug machine at outlet.
2. Remove engine compartment cover (refer to page 2: Removing Engine Compartment Cover).
3. Use 1/4" wrench and remove the four hexhead bolts from the pump head plate (fig. 6).
4. Pull impeller out of pump head with needle-nose pliers (fig 7).
5. Remove any debris (hair, lint etc.) that may have accumulated in pump head.
6. Insert new impeller.

RULE OF THUMB: When pump is new, the pump head plate is sealed with three paper gaskets (fig. 8). Depending on how well your pump is priming, you may need to remove one or possibly two of these gaskets. Also, if the pump head plate is worn, you may need to flip it over when you install it back on the pump head.

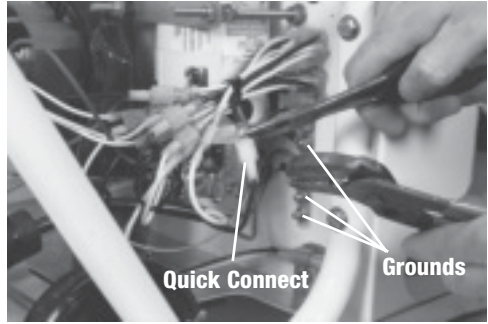

Figure 5

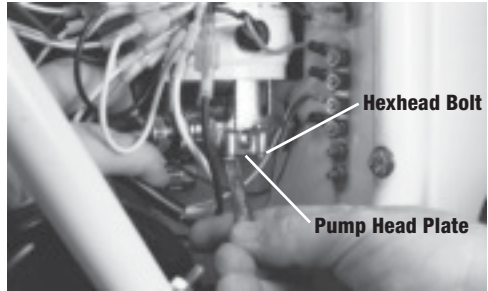

Figure 6

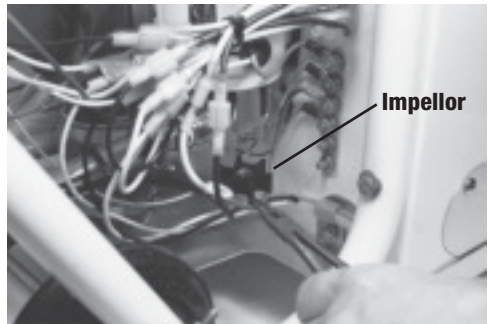

Figure 7

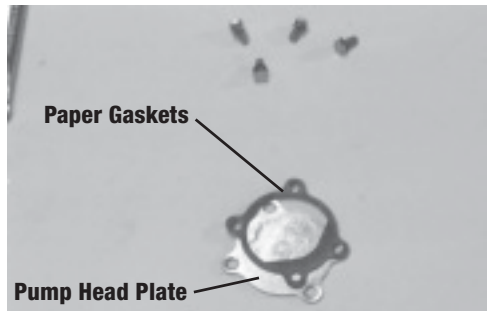

Figure 8

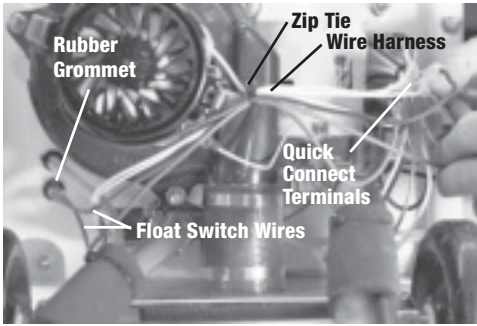

Figure 9

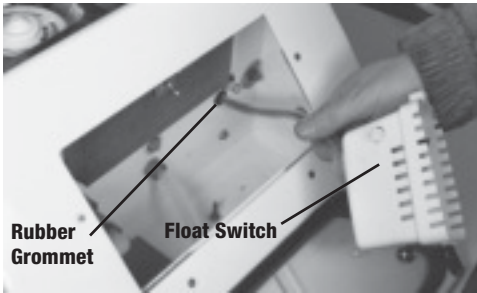

Figure 10

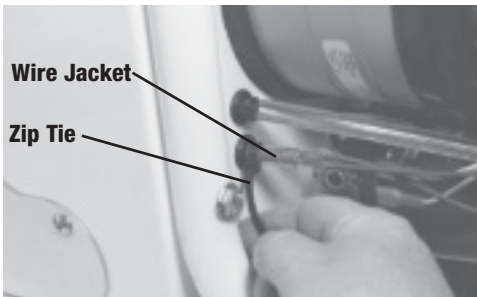

Figure 11

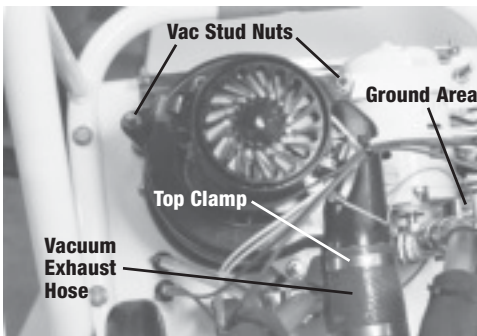

Figure 12

Replacing Float Switch

1. Unplug machine at outlet.
2. Remove engine compartment cover (refer to page 2: Removing Engine Compartment Cover).
3. Locate the float switch's two electric wires and disconnect them at their quick-connect terminals (fig. 9).
4. Carefully cut zip-ties from wire harness (fig. 9).
5. Remove thumb-nut from float switch and pull float wires through rubber grommet (fig. 10).
6. Insert new float switch. Moisten float switch's wire jacket (fig. 11) before pushing through rubber grommet. Once installed firmly zip-tie wire jacket as shown (fig. 11).

7. Zip-tie wire harness.
8. Reattach quick-connect terminals (refer to page 16: Engine Compartment Terminal Block Diagram).

9. Reattach float switch with brass thumb nut.

Replacing Vacuum Motor

1. Unplug machine at outlet.
2. Remove engine compartment cover (refer to page 2: Removing Engine Compartment Cover).
3. Loosen top clamp on vacuum exhaust hose (fig. 12).
4. Remove three vacuum studnuts (fig. 12).

5. Remove the vacuum motor's ground wire from the machine's ground (fig. 12).

6. Disconnect vacuum motor's black and white wire at their quick-connect terminals (fig. 13).

7. Remove and replace vacuum motor. Reattach vacuum exhaust hose with top clamp. Tighten vacuum motor back up with the vacuum stud nuts (do not overtighten or you may crack the plastic mounting flanges on vacuum motor).

8. Reattach black and white wires and ground wire (refer to page 16: Engine Compartment Terminal Block Diagram).

Replacing Solenoid

1. Unplug machine at outlet.

2. Remove engine compartment cover (refer to page 2: Removing Engine Compartment Cover).

3. Pull both insulated terminals off solenoid (fig. 14).

4. Remove compression fitting nut and nylon washers from inside of recovery tank (fig. 15).

5. Remove solenoid.

6. Loosen clamp and remove pressure hose whip (fig. 14).

7. Unscrew and remove green ground wire (fig. 14).

8. Reattach green ground wire and pressure hose whip on new solenoid.

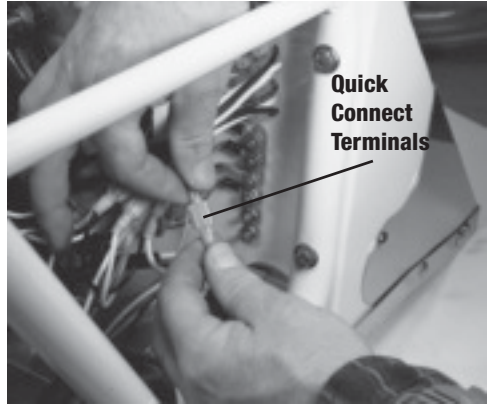

Figure 13

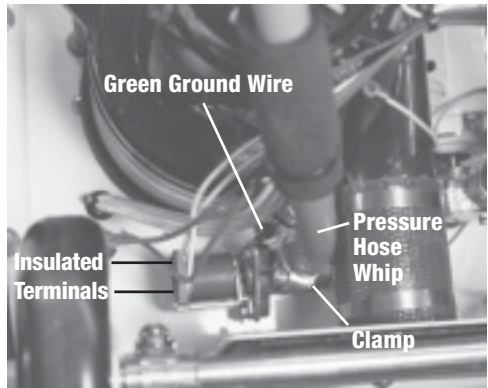

Figure 14

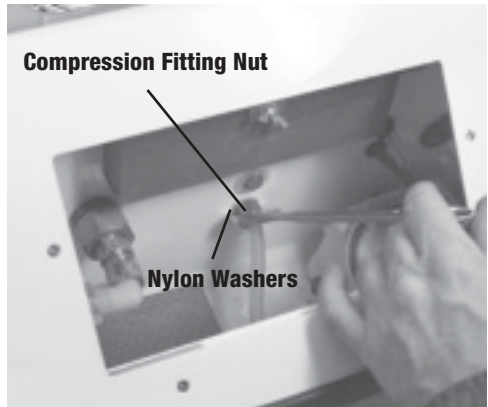

Figure 15

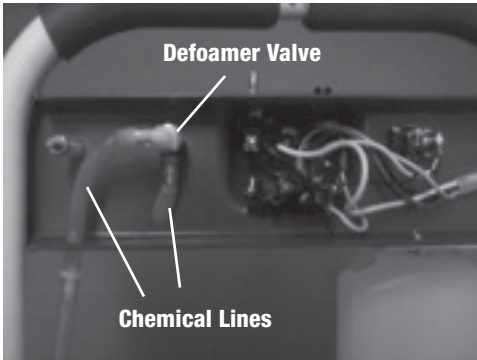

Figure 16

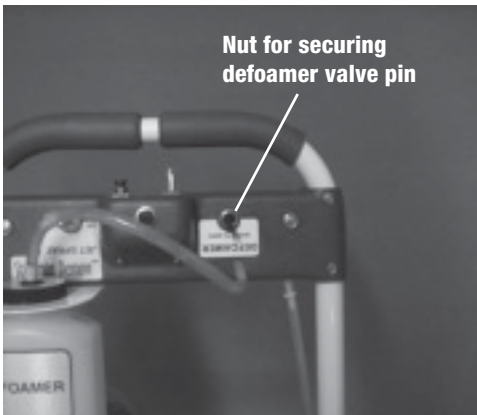

Figure 17

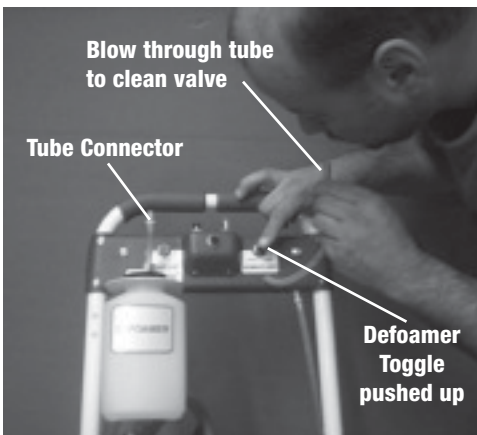

Figure 18

9. Reattach solenoid with compression fitting nut and nylon washers.

10. Reattach the two insulated terminals to solenoid.

Replacing Defoamer Valve

1. Unplug machine at outlet.
2. Remove back plate of control panel (fig. 16).
3. Wiggle both defoamer chemical lines off their nylon fittings (fig. 16).
4. Remove and replace defoamer valve. Make sure the top threads of valve are covered with the tightening nut. If not, the pin that holds the toggle paddle in the valve will loosen and fall out (fig. 17).

Cleaning Defoamer Valve

Pull loose the tube connector and wipe off the tube. Next, open the defoamer valve and blow through the tube to clean out the valve (fig. 18).

Removing and Replacing Switches

1. Unplug machine at outlet.
2. Remove backplate of control panel and remove the bad switch.(fig. 16).
3. Important: Refer to page 16: Control Panel Terminal Block Diagram whenever removing and replacing any electrical switches.

PARTS LIST

VIEW 1: Adapter Caddie Contents

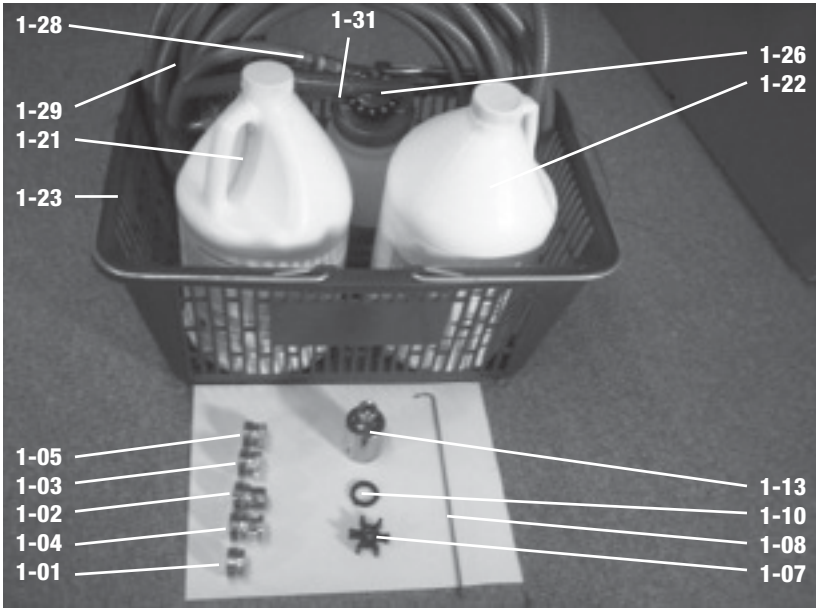

- | | | | |
|------|--|------|---|
| 1-01 | Standard Fitting | 1-20 | Spotter (not shown) |
| 1-02 | Standard Extended Fitting | 1-21 | Bubble-Blaster Defoamer |
| 1-03 | 13/16" Male Fitting | 1-22 | Demon Clean Carpet Prespray |
| 1-04 | 3/4" Female Fitting | 1-23 | Caddie |
| 1-05 | 13/16" Female Fitting | 1-24 | Repair & Parts Manual
(not shown) |
| 1-07 | Impeller | 1-26 | Dial-A-Mix Sprayer |
| 1-08 | Lip Hook | 1-28 | 5/8 Single Ear Clamp |
| 1-10 | Garden Hose Washer | 1-29 | 33 ft. Pressure Hose (sockets
both ends) |
| 1-11 | Permanent Fitting (optional-
not shown) | 1-31 | Fan Spray Tip |
| 1-13 | 1-1/16" Socket Adapter
(optional) | | |
| 1-15 | Operating Manual
(not shown) | | |
| 1-16 | Pump Gaskets (not shown) | | |
| 1-17 | Crimping Tool (not shown) | | |
| 1-18 | Set of 5 Sink Fittings
(not shown) | | |
| 1-19 | Metric Sink Fitting (not shown) | | |

PARTS LIST

VIEW 2: Left Side Engine Compartment

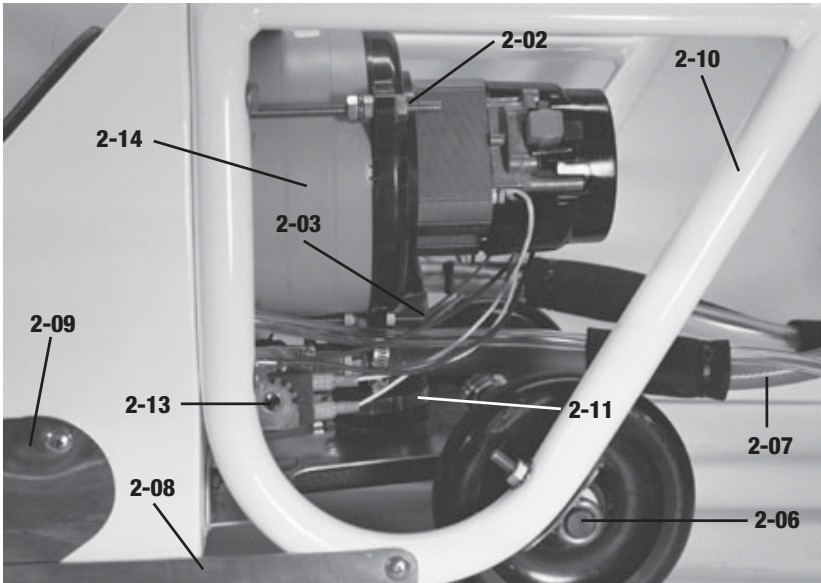

- 2-01 Vacuum Motor, 3 stage, 10.7 amp (not shown)
- 2-02 Vacuum Stud Nut
- 2-03 Vacuum Exhaust Tube
- 2-06 Axle Assembly
- 2-07 Solenoid Hose Whip & Swivel Fitting
- 2-08 Outer Lip
- 2-09 Wing Brace (Left or Right)
- 2-10 Handle (Left or Right)
- 2-11 Vacuum Exhaust Tube Clamp
- 2-12 Vac Gasket (not shown?)
- 2-13 Solenoid Assembly
- 2-14 Vacuum Motor (2 stage, 11.7 amp)

PARTS LIST

VIEW 3: Right Side of Engine Compartment

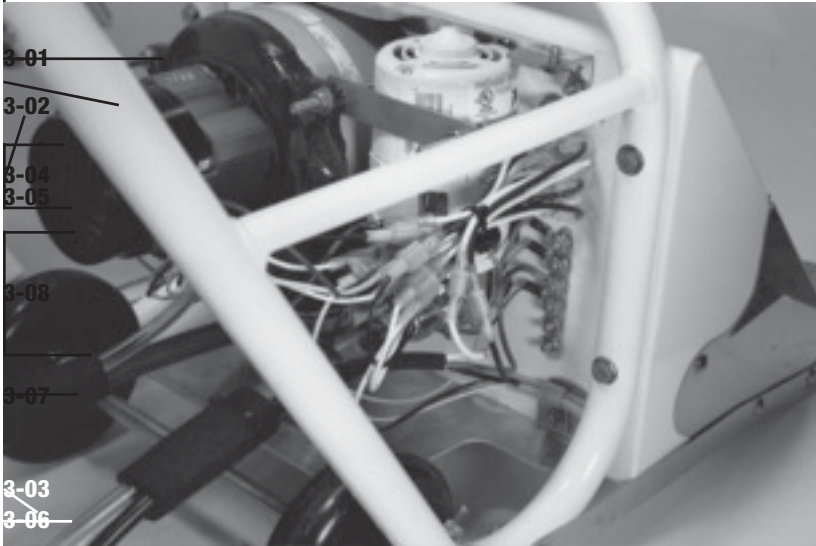

- 3-01 Dogbone
- 3-02 Discharge Pump (prepped and assembled)
- 3-03 Discharge Pump Hose Whip with Swivel
- 3-04 Engine Compartment Terminal Block
- 3-05 Pump Support
- 3-06 Electric Plug
- 3-07 Jiffy Clamp
- 3-08 Grounds

PARTS LIST

VIEW 4: Front View

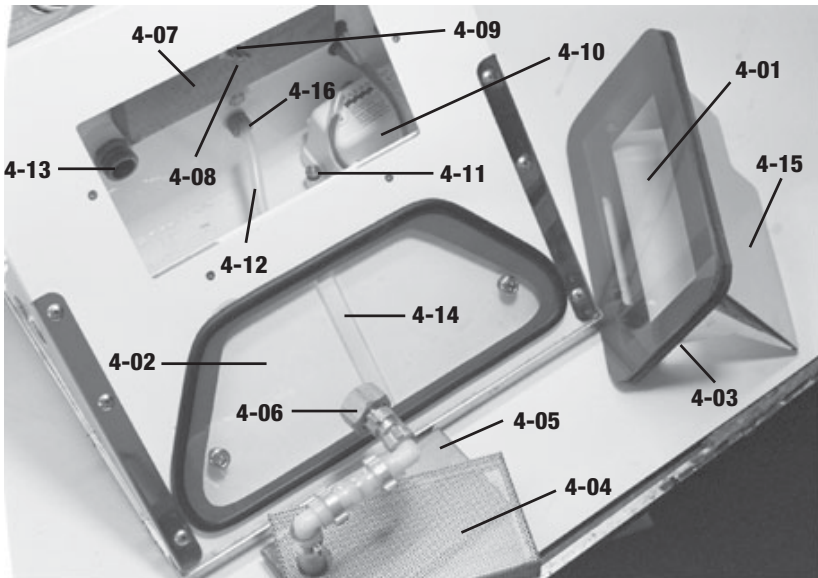

- 4-01 Window Channel Assembly (off to side)
- 4-02 Water Channel Assembly
- 4-03 Window Channel Inner Gasket
- 4-04 Lint Filter (off to side)
- 4-05 Primary Water Filters (assembled)
- 4-06 Water Filter Garden Hose Swivel Nut Assembly
- 4-07 Air Filter
- 4-08 Wing Nut
- 4-09 Middle Brace
- 4-10 Float Switch (prepped)
- 4-11 Knurl Nut
- 4-12 Spray Jet Supply Line
- 4-13 Pump Mount Brass Fitting
- 4-14 Middle Channel
- 4-15 Channel
- 4-16 Compression Fitting

PARTS LIST

VIEW 5: Underside of Machine

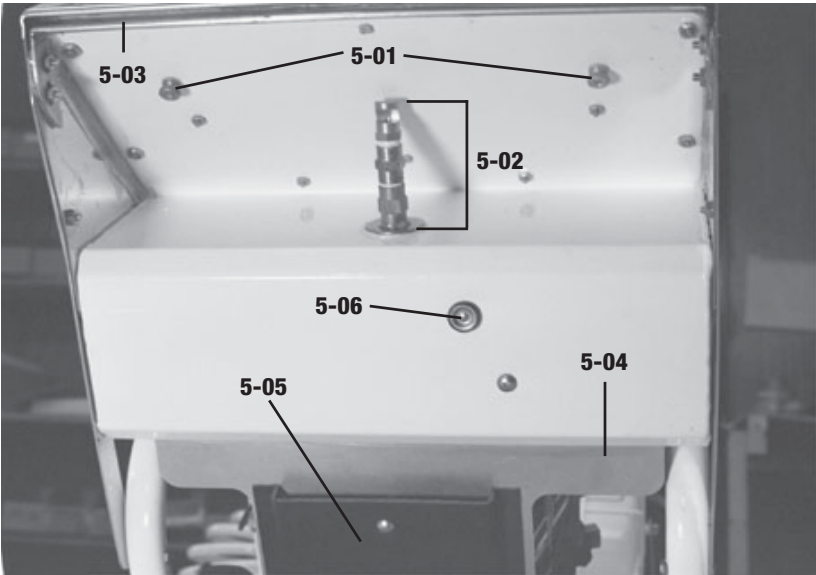

- 5-01 Water Channel Knurl Nuts
- 5-02 Spray Jet Assembly
- 5-03 Inner Lip
- 5-04 Exhaust Flange Assembly
- 5-05 Exhaust Flange Baffle
- 5-06 Drain Plug

PARTS LIST

VIEW 6: Top Half of Handle

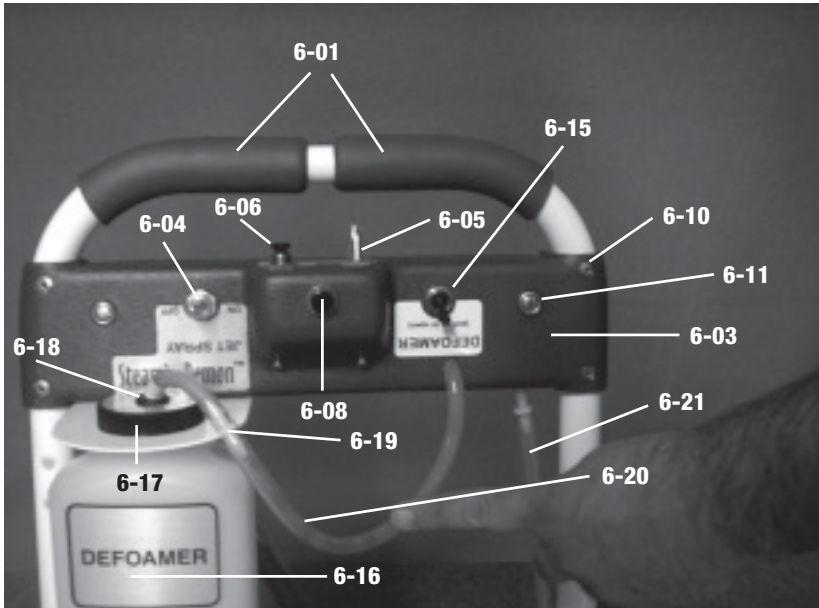

- | | | | |
|------|-------------------------------------|------|---|
| 6-01 | Handle Grip | 6-21 | Handle Defoamer Line |
| 6-02 | Hose Hanger (not shown, see view 7) | 7-15 | Quart Bottle & Cap (not prepped, not shown) |
| 6-03 | Control Panel (Front Plate) | 8-02 | Control Panel Back Plate (not shown) |
| 6-04 | Jet Spray Toggle Switch | | |
| 6-05 | Vacuum Motor Toggle Switch | | |
| 6-06 | Jet Spray Push Button Switch | | |
| 6-08 | Indicator Light & Clip | | |
| 6-10 | Control Panel Rivet | | |
| 6-11 | Control Panel Mounting Bolt | | |
| 6-14 | Toggle Boot | | |
| 6-15 | Defoamer Valve | | |
| 6-16 | Defoamer Quart Bottle (prepped) | | |
| 6-17 | Defoamer Bottle Cap (prepped) | | |
| 6-18 | Grommet | | |
| 6-19 | Tube Connector | | |
| 6-20 | Defoamer Line | | |

PARTS LIST

VIEW 7: Rear View

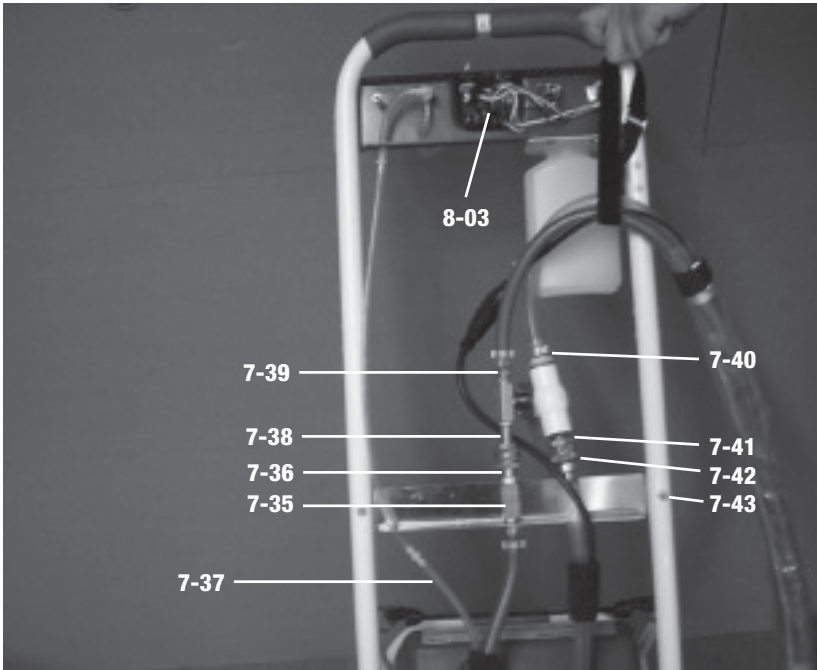

- 7-35 Tee- 1/4F x 1/4F x 1/4M
- 7-36 3/4MGH x 1/4FPT
- 7-37 Defoamer Tube
- 7-38 3/4FGH Swivel x 1/4MPT
- 7-39 1/4MPT x 3/8 Barb
- 7-40 1/2MPT x 1/2 Barb (nylon)
- 7-41 1/2MPT x 3/4MGH
- 7-42 3/4FGH Swivel x 1/2 Barb
- 7-43 10-24 Keps Nut
- 8-03 Control Panel Terminal Block

PARTS LIST

VIEW 9: Front View

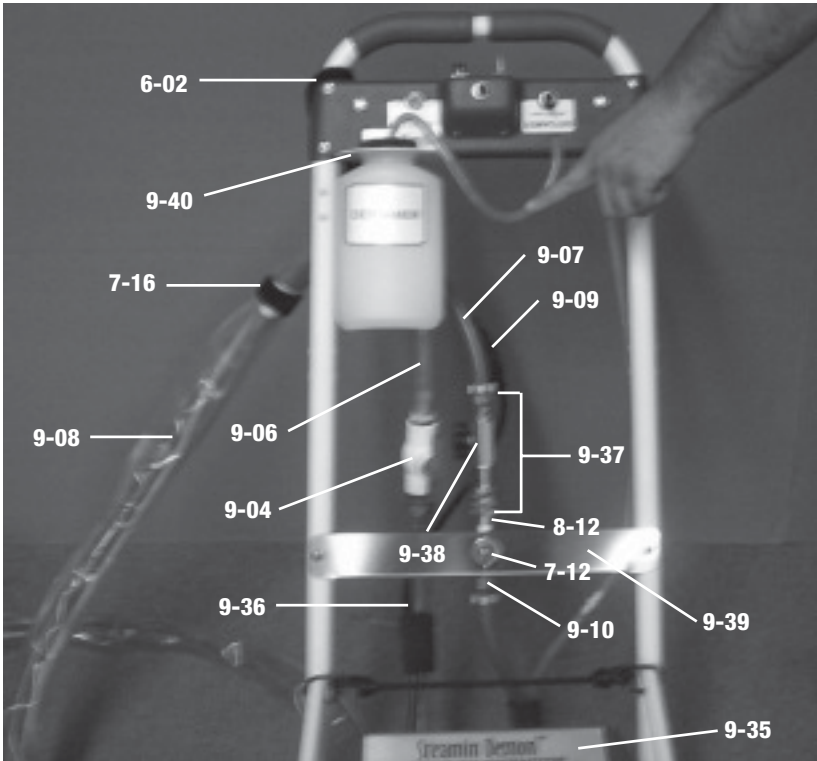

- 6-02 Hose Hanger
- 8-12 Screen Washer
- 9-02 Thumb Knobs (not shown)
- 9-04 Machine Drain Valve Assembly
- 9-06 Drain Hose
- 9-07 Pressure Hose
- 9-08 Hose Jacket
- 9-09 Electric Cord 50 ft. (14GA-3 wire)
- 9-10 Pressure Hose Whip Swivel Fitting
- 9-35 Engine Compartment Cover w/sticker & Air Intake Filter
- 9-36 Drain Line Hose Whip Swivel Fitting Assembly
- 9-37 Machine Pressure Valve Assembly
- 9-38 Supply Hose Valve 1/4"
- 9-39 Classic Prespray Extension
- 9-40 Bottle Holder

PARTS LIST

VIEW 10: 50' Supply & Drain Hose and Stair/Furniture Assembly

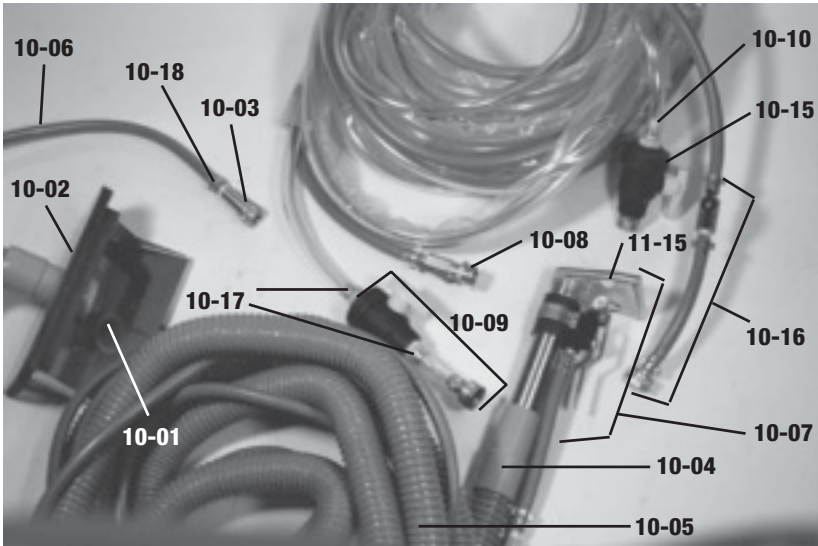

10-01	Hand Tool Window Channel	10-16	Female Pressure Valve
10-02	Vacuum Block Gasket	10-17	3/4" Ear Clamp
10-03	Socket	10-18	5/8" Ear Clamp
10-04	Hose Cuff	10-19	50' Supply, Drain & Power Cord Assembly (not shown)
10-05	Vacuum Hose 1 1/2" (25 ft.)	11-15	Hand Tool Head Only
10-06	Pressure Hose, 25 ft. (with sockets on both ends)	12-01	Special Order Parts
10-07	Hand Tool (specify stair or upholstery)		
10-08	Pressure Valve Male Assembly		
10-09	Drain Valve Female Assembly		
10-10	Drain Hose, 50 Ft.		
10-11	Pressure Hose 50 Ft.		
10-12	50 Ft. Section Extra Hoses		
10-13	Stair Tool Assembly (single head)		
10-14	Stair/Furniture Tool Assembly (dual head)		
10-15	Male Drain Valve Assembly		

1. Control Panel Terminal Block Diagram
 (See front end of machine)

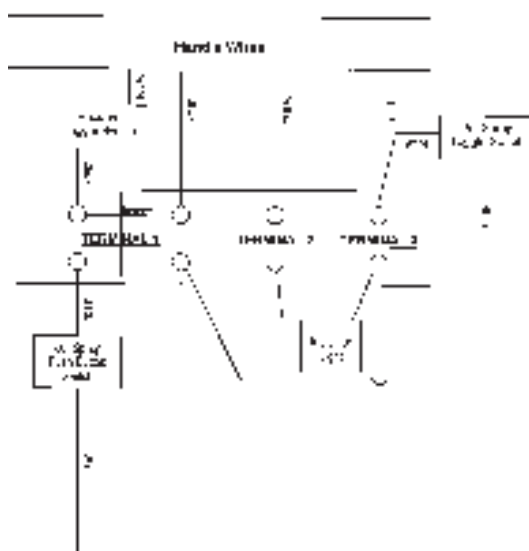

1. Control Panel Terminal Block Diagram

2. Engine Compartment Terminal Block Diagram
 (See front end of case)

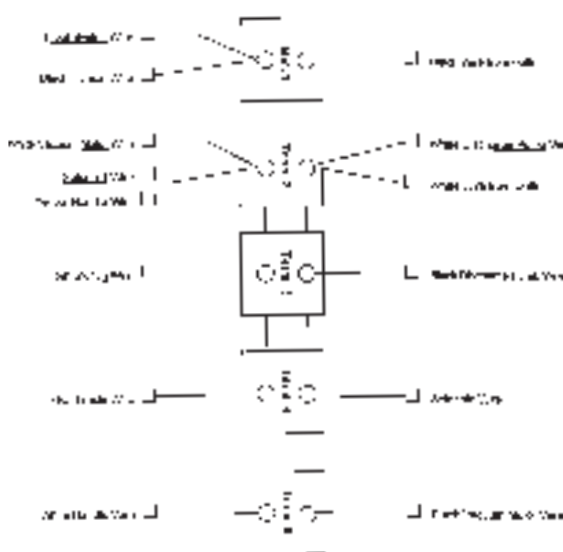

2. Engine Compartment Terminal Block Diagram